

1		
Description	Material	Finish
Body	Brass	Gold
Pin	BE CU	Gold
Insulation	Teflon	Teflon
Lock Washer	BE CU	Gold
Support	Brass	Gold
Spacer	Teflon	Teflon

SIDE VIEW

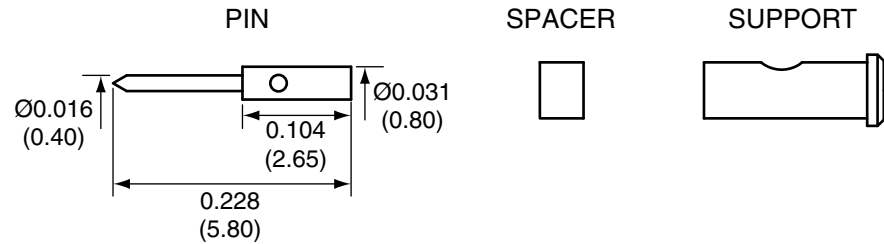

RECOMMENDED CABLE STRIPPING DIMENSIONS

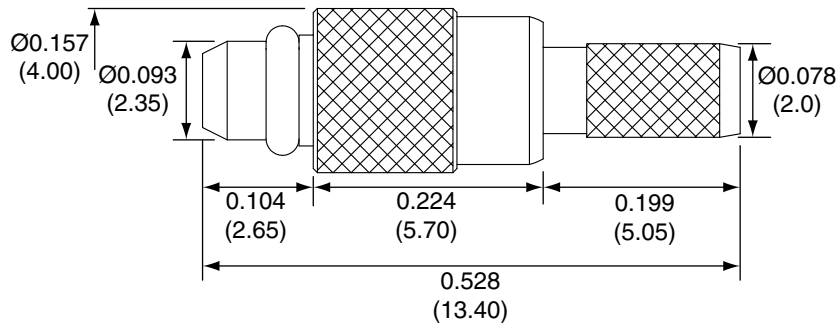
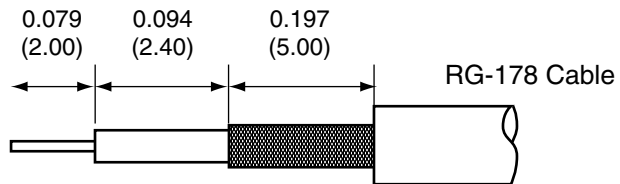

CONMMCX007-R178 ASSEMBLY INSTRUCTIONS

1. Strip the cable to the recommended dimensions.
2. Solder the support onto the braid.
3. Place the spacer onto the center conductor.
4. Solder or crimp the pin onto the center conductor.
5. Insert the pin, center conductor, spacer, and support into the body until the top of the pin is even with the body.
6. Crimp the tail of the body onto the support with a hex crimp tool.

Title		CONMMCX007-R178	
MMCX MALE CABLE END CRIMP FOR RG178 CABLE		Revision: 1.5	
Part No.	CONMMCX007-R178	Date:	9/05/2008
Dimensions:	INCHES (mm)	Sheet 1 of 1	

CONNECTOR CITY
159 ORT LANE
MERLIN, OR 97532
PH (541)-471-6256
FAX (541)-471-6251

CONNECTOR CITY
THE VALUE OF CONNECTIONS